

# TC-H7700D

## SERVICE MANUAL

*AEP Model  
UK Model*

This set is the cassette deck  
section in MHC-7700D/7710D

- TC-H7700D is similar to the earlier TC-H5600 (AEP, UK model).
- Refer to **TC-H5600** service manual for information not contained in this service manual.

STEREO CASSETTE DECK  
**SONY**®

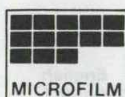

Sony Corporation  
Audio Group

Published in Heiloo, Holland.

PAGE 41.

NOTE:

- The mechanical parts with no reference number in the exploded views are not supplied.
- Items marked "\*" are not stocked since they are seldom required for routine service. Some delay should be anticipated when ordering these items.

- -XX and -X mean standardized parts, so they may have some difference from the original one.

● Color Indication of Appearance Parts

NOB, BALANCE (WHITE)... (RED)

Parts	Color	Cabinet's Color
1	Black	Black
2	Black	Black
3	Black	Black
4	Black	Black
5	Black	Black
6	Black	Black
7	Black	Black
8	Black	Black
9	Black	Black
10	Black	Black
11	Black	Black
12	Black	Black
13	Black	Black
14	Black	Black
15	Black	Black
16	Black	Black
17	Black	Black
18	Black	Black
19	Black	Black
20	Black	Black
21	Black	Black
22	Black	Black
23	Black	Black
24	Black	Black
25	Black	Black
26	Black	Black
27	Black	Black
28	Black	Black
29	Black	Black
30	Black	Black
31	Black	Black
32	Black	Black
33	Black	Black
34	Black	Black
35	Black	Black
36	Black	Black
37	Black	Black
38	Black	Black
39	Black	Black
40	Black	Black
41	Black	Black
42	Black	Black
43	Black	Black
44	Black	Black
45	Black	Black
46	Black	Black
47	Black	Black
48	Black	Black
49	Black	Black
50	Black	Black
51	Black	Black
52	Black	Black
53	Black	Black
54	Black	Black
55	Black	Black
56	Black	Black
57	Black	Black
58	Black	Black
59	Black	Black
60	Black	Black
61	Black	Black
62	Black	Black
63	Black	Black
64	Black	Black
65	Black	Black
66	Black	Black
67	Black	Black
68	Black	Black
69	Black	Black
70	Black	Black
71	Black	Black
72	Black	Black
73	Black	Black
74	Black	Black
75	Black	Black
76	Black	Black
77	Black	Black
78	Black	Black
79	Black	Black
80	Black	Black
81	Black	Black
82	Black	Black
83	Black	Black
84	Black	Black
85	Black	Black
86	Black	Black
87	Black	Black
88	Black	Black
89	Black	Black
90	Black	Black
91	Black	Black
92	Black	Black
93	Black	Black
94	Black	Black
95	Black	Black
96	Black	Black
97	Black	Black
98	Black	Black
99	Black	Black
100	Black	Black

### 6-1. FRONT PANEL SECTION

- A: MAIN (A) BOARD
- B: MAIN (B) BOARD
- C: MAIN (C) BOARD
- D: MAIN (D) BOARD
- E: MAIN (E) BOARD

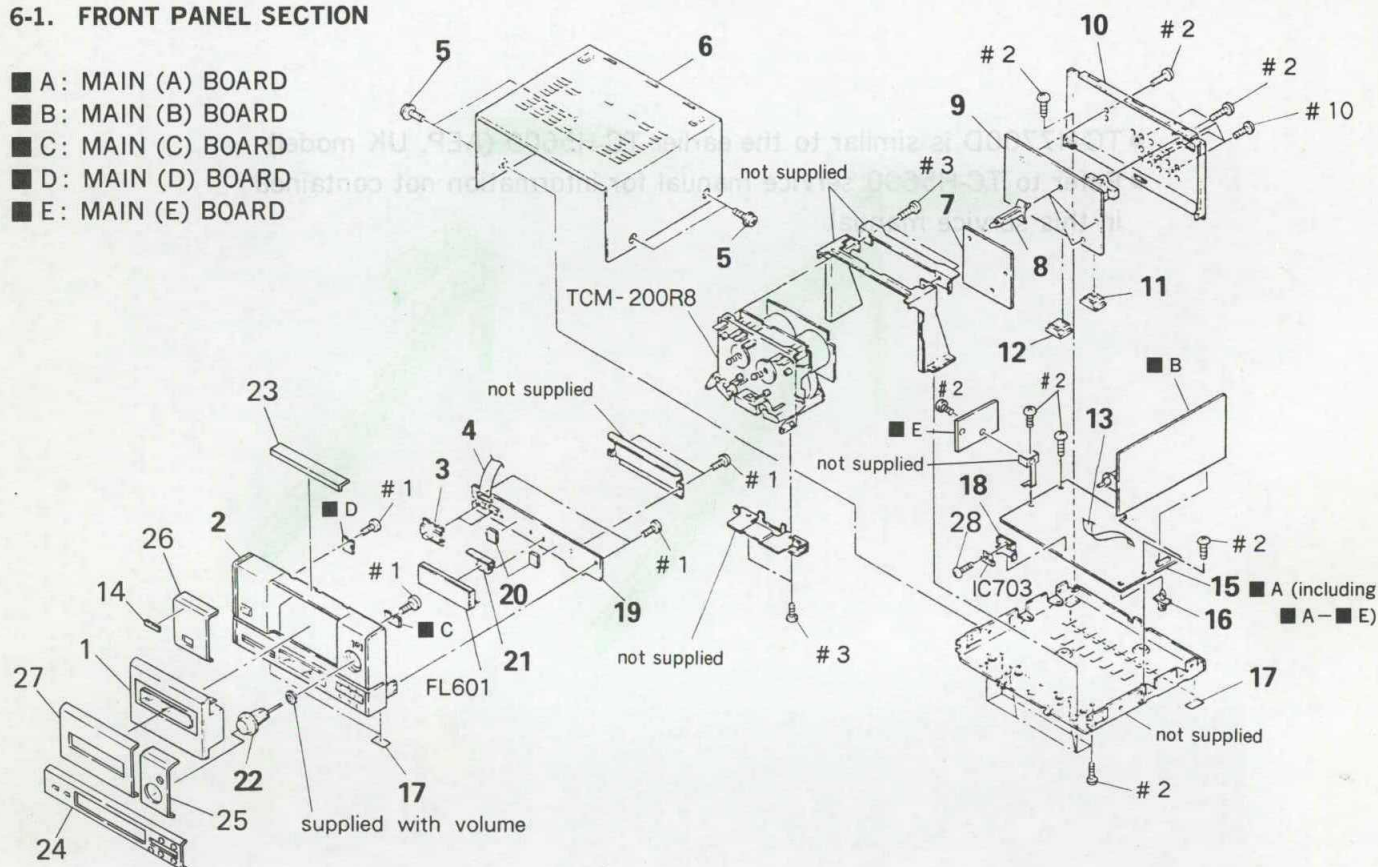

Ref. No.	Part No.	Description	Remark
1	X-3365-295-1	LID ASSY, CASSETTE	
2	X-3365-293-1	PANEL ASSY, FRONT	
3	3-368-105-11	KNOB (SLIDE)	
4	1-575-906-11	WIRE, FLAT TYPE (15 CORE)	
5	3-363-099-11	SCREW (CASE +3X8 TP2)	
6	4-932-841-81	CASE	
* 7	1-639-415-11	POWER BOARD	
* 8	3-703-353-02	SUPPORT, PC BOARD	
* 9	A-2006-548-A	JACK BOARD, COMPLETE	
* 10	3-375-194-11	PANEL, BACK (AEP, UK)	
* 10	3-375-194-02	PANEL, BACK (Germany)	
* 11	1-573-188-11	CONNECTOR, BRIDGE 7P	
* 12	1-573-389-11	CONNECTOR, BRIDGE 8P	
13	1-575-903-11	WIRE, FLAT TYPE (15 CORE)	
14	4-942-636-11	EMBLEM (No. 3.5), SONY	
* 15	A-2006-452-A	MAIN BOARD, COMPLETE	

Ref. No.	Part No.	Description	Remark
* 16	3-350-847-31	HOLDER, PCB	
17	4-930-336-21	FOOT (FELT)	
* 18	3-356-925-01	HEAT SINK	
* 19	A-2006-453-A	PANEL BOARD, COMPLETE	
* 20	4-921-941-01	CUSHION (FL)	
* 21	3-368-109-01	HOLDER, FL TUBE	
22	X-3365-294-1	KNOB (REC VOL) ASSY	
23	3-367-893-51	PLATE (TOP), ORNAMENTAL	
24	3-368-095-11	PLATE (PANEL), ORNAMENTAL	
25	3-368-097-11	PLATE (R), ORNAMENTAL	
26	3-368-096-11	PLATE (L), ORNAMENTAL	
27	3-368-098-11	PLATE (CASSETTE), ORNAMENTAL	
28	7-682-548-04	SCREW +BVTT 3X8 (S)	
FL601	1-519-656-11	INDICATOR TUBE, FLUORESCENT	
IC703	8-759-973-95	IC BA6219B	