

PS-LX51P

SERVICE MANUAL

E Model



SPECIFICATIONS

Turntable	
Platter	30cm (12 in.)
Motor	DC servo motor
Drive system	Belt drive
Speed	33 1/3 rpm/45 rpm switchable
Wow and flutter	0.25%(WRMS)
Signal-to-noise ratio	45dB (DIN-B)
Automatic system	Return, reject
Tonearm	
Type	Dynamically balanced
Pivot-to-stylus length	203 mm (8 in.)
Overall arm length	235 mm (9 1/4 in.)
Cartridge	
Type	Moving magnet type
Frequency response	20 Hz-20kHz
Stylus	CN-234
General	
Dimensions	355x97x342 mm(w/h/d) (14x3 5/6x13 1/2 inches)
Weight	Approx. 2.6kg (5 lb 12 oz)
Power requirements	220V AC50Hz (PS-LX49) 12V DC (PS-LX49P)
Power consumption	2W
Accessory supplied	45-rpm adaptor (1)
Optional accessories	Replacement stylus CN-234 Stat spray XP-C10 Cleaner XP-C1, XP-C2

Design and specifications subject to change without notice.

Note

This appliance conforms with EEC Directive 87/308/EEC regarding interference suppression.

REPLACING THE STYLUS

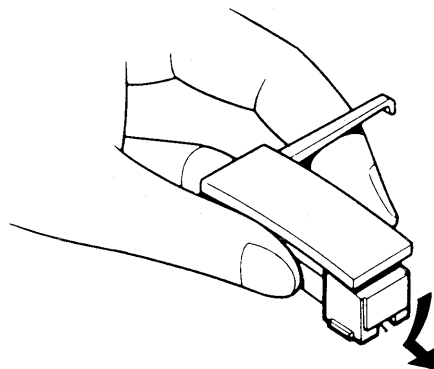

Replace the stylus after about 400 hours of use because using a worn stylus will damage records. An CN-234 replacement stylus is available at your Sony dealer.

Be sure to turn the amplifier off before proceeding with replacement.

- 1 While holding the cartridge, detach the stylus assembly as illustrated.
- 2 Insert the new stylus into the cartridge.

STEREO TURNTABLE SYSTEM
SONY®

REPAIRING PRECAUTION

[To supply B+ voltage]

The power of this unit is fed from HST model. Because of this, connect the regulated power supply as illustrated right when this unit alone operates.

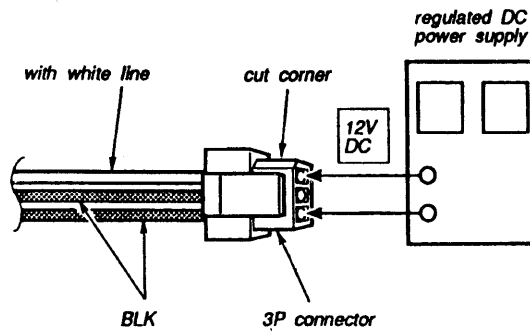

LOCATION AND FUNCTION OF CONTROLS

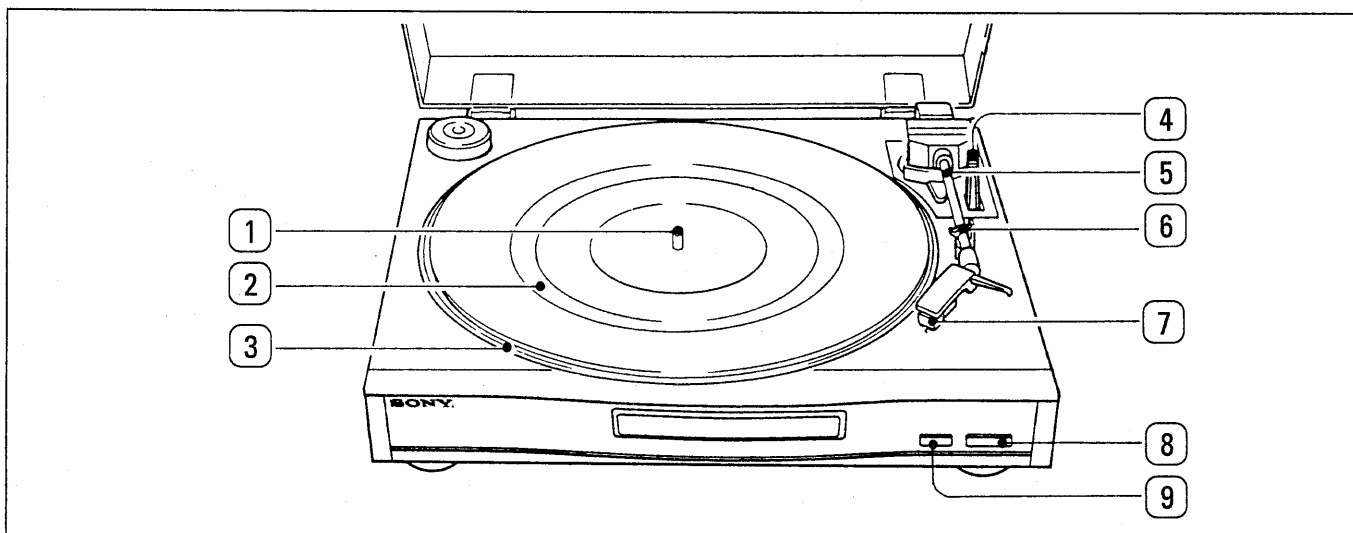

- 1 Center spindle
- 2 Rubber mat
- 3 Turntable platter
- 4 Cueing lever (▼ / ▼)
- 5 Tonearm
- 6 Arm rest
- 7 Cartridge
- 8 REJECT button
- 9 SPEED select button

Allows selection of 45rpm or 33rpm turntable speed.

TURNTABLE ASSEMBLY

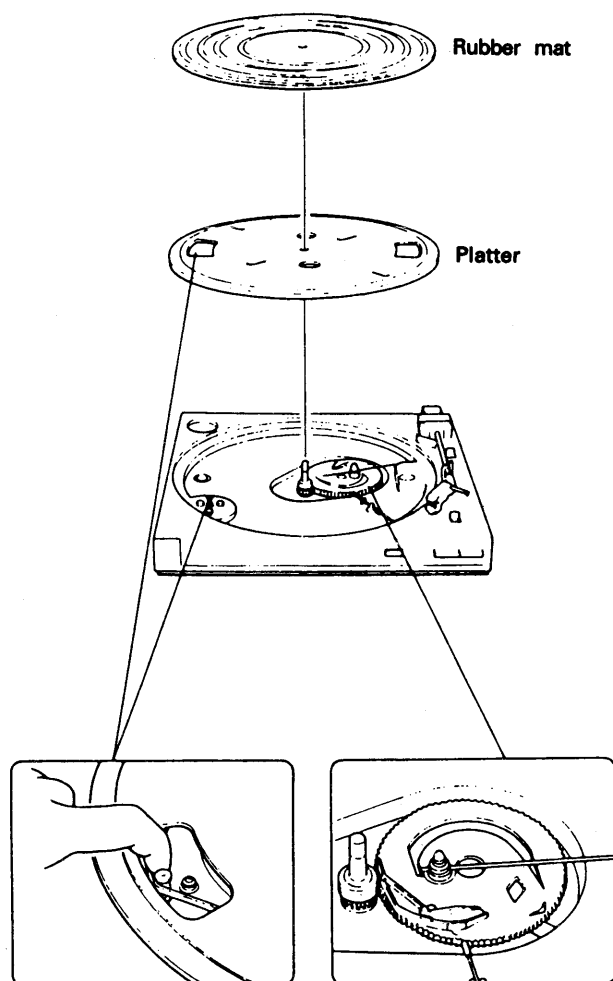

Hook the belt on the motor pulley.
If the belt is removed from the platter, replace it with the glossy side outward.

Stylus Drop-point Adjustment

1. Place a test record (YFSC-16) on the turntable sheet.
2. Set the SPEED switch to 33.
3. Press the START button.
4. By using a screwdriver, turn the adjustment screw so that the stylus tip drops on the record at the 7-17 counts position.
5. Move the arm to return detecting groove and confirm that the auto-return operation is started normally.

Note: The proper adjustment for a 30cm record is also correct for a 17cm record.
when turning adjustment screw, put the arm on the arm rest.

Speed Adjustment

Note: Be sure to perform 45rpm adjustment before 33rpm.

1. Place a stroboscope board on the turntable sheet.
2. Set the SPEED switch to 45.
Press the START button.
Adjust VR2 so that the striped pattern of stroboscope board is stationary.
3. Set the SPEED switch to 33.
Adjust VR1 in the same way.

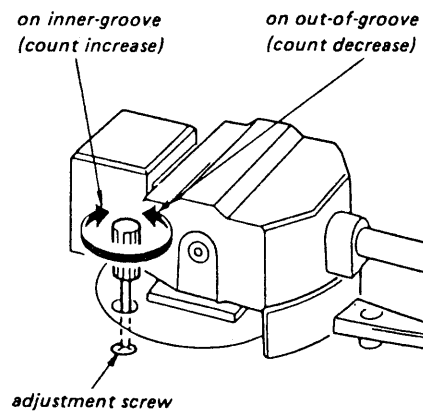
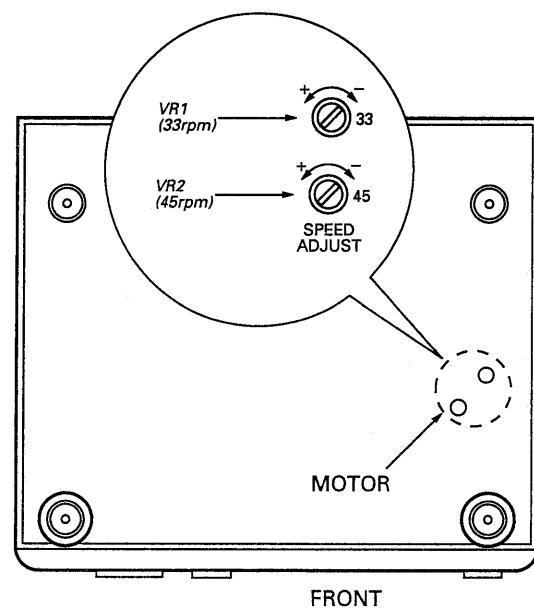

PS-LX51P

SCHEMATIC DIAGRAM

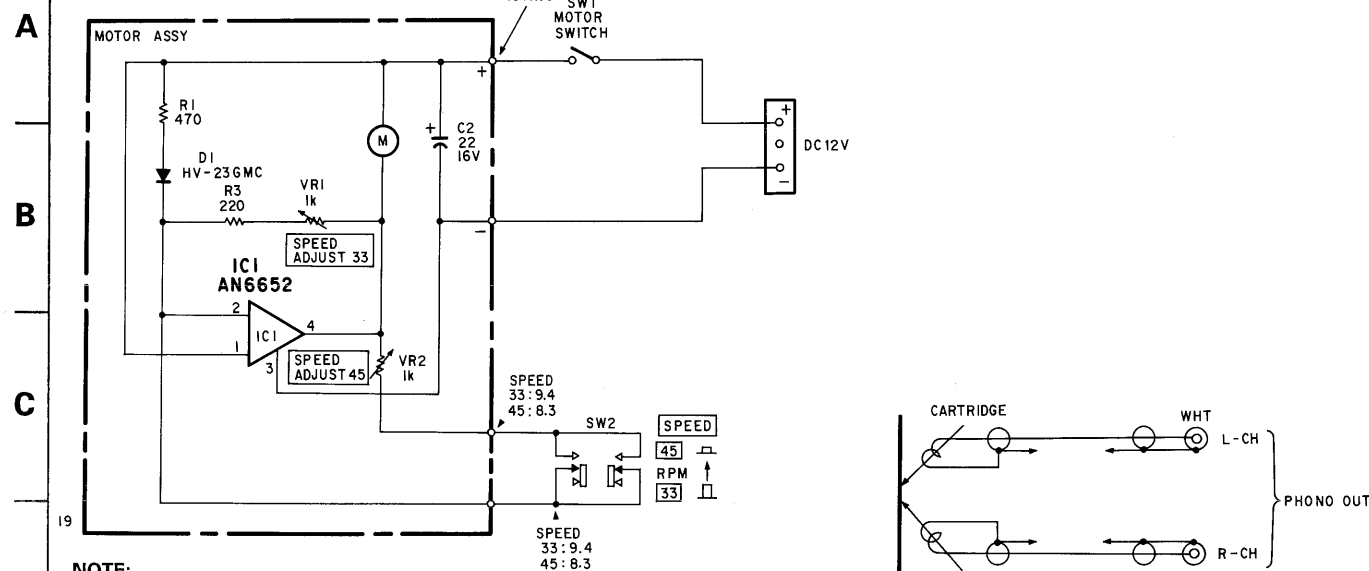

NOTE:

- All capacitors are in μF unless otherwise noted. pF : μF 50V or less are not indicated except for electrolytics and tantalums.
- All resistors are in Ω and $1/4\text{W}$ or less unless otherwise specified.

Switches:

Ref.No.	Switch	Position
SW1	MOTOR	OFF
SW2	SPEED	33
SW3	POWER	OFF

The components identified by mark Δ or dotted line with mark Δ are critical for safety.
Replace only with part number specified.

WIRING DIAGRAM

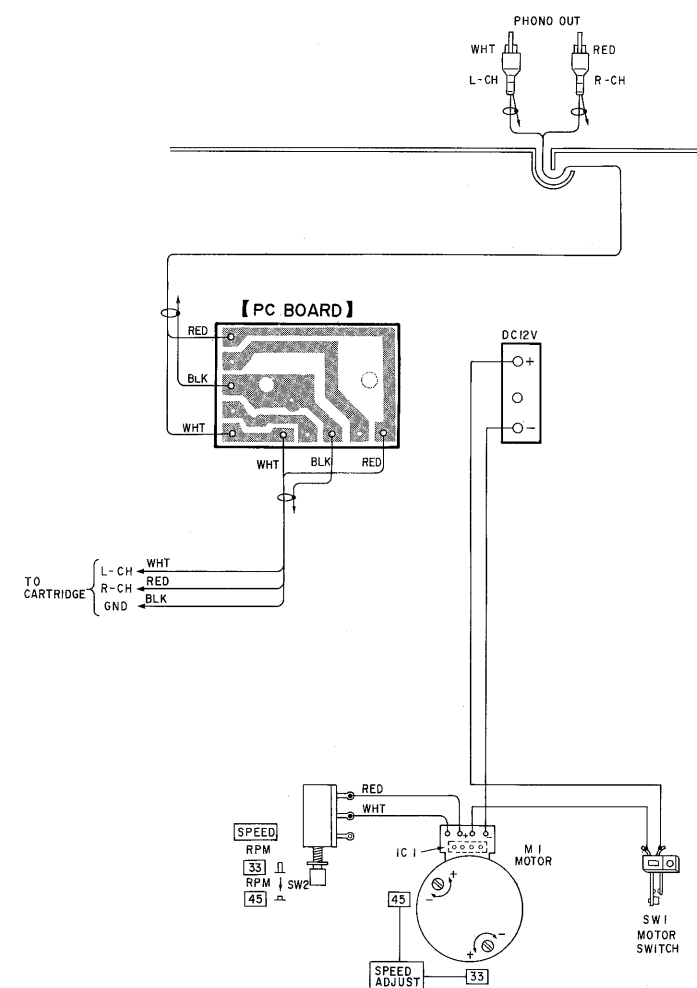

EXPLODED VIEW

NOTE:

- -XX, -X mean standardized parts, so they may have some differences from the original one.
- The construction parts of an assembled part are indicated with a collation number in the remark column.
- Items marked "*" are not stocked since they are seldom required for routine service. Some delay should be anticipated when ordering these items.
- The mechanical parts with no reference number in the exploded views are not supplied.
- Screw(# mark) list is given in the last of this parts list.

The components identified by mark Δ or dotted line with mark Δ are critical for safety.
Replace only with part number specified.

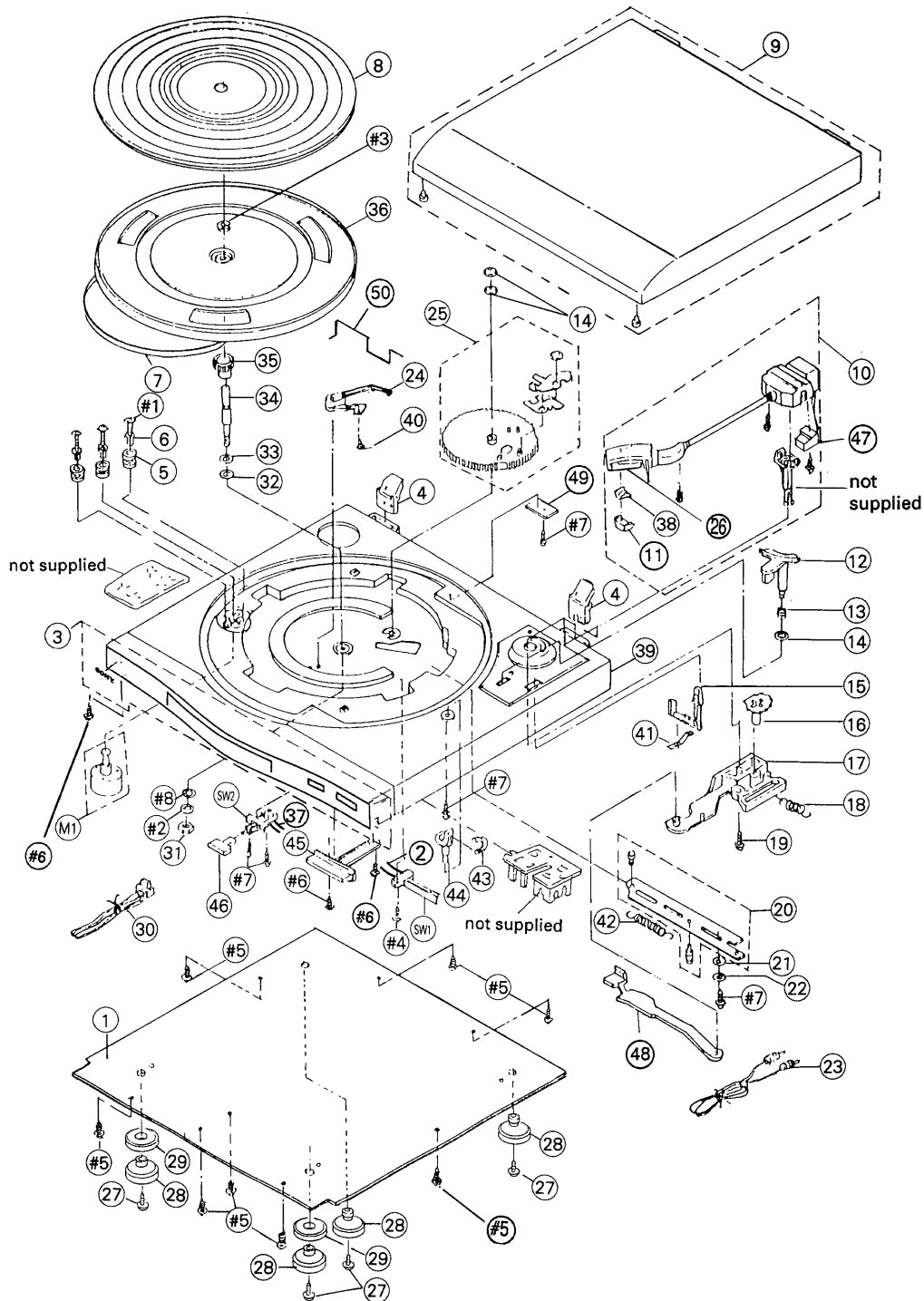

Ref.No.	Part No.	Description	Remarks	Ref.No.	Part No.	Description	Remarks
1	4-950-488-01	BOTTOM BOARD		6	4-947-504-01	COLLAR	
2	1-696-144-11	WIRE (45) RED		7	4-947-503-01	BELT	
3	A-4660-304-A	PANEL ASSY, FRONT		8	A-4674-087-A	TURN TABLE MAT ASSY	
4	4-947-476-01	HINGE		9	A-4604-946-A	COVER ASSY, DUST	
5	4-947-505-01	CUSHION, MOTOR					

Ref.No.	Part No.	Description	Remarks	Ref.No.	Part No.	Description	Remarks
10	A-4604-940-A	ARM ASSY, TONE		30	1-557-109-21	DC CORD	
11	4-948-095-01	COVER CARTRIDGE		31	4-947-510-01	NUT	
12	4-947-466-01	TONE ARM ELEVATOR		32	3-451-162-01	WASHER (56)	
13	4-947-467-01	SPRING (6)		33	3-701-445-21	WASHER	
14	4-947-514-01	4MM CS RING		34	4-947-498-01	STELL BALL	
15	4-947-468-01	LEVER, CUEING		35	4-947-497-01	GEAR	
16	4-947-470-01	ADJUST CAM		36	4-947-494-01	TURNTABLE PLATTER	
* 17	4-947-471-01	LINK, RETURN		37	1-696-143-11	WIRE (30) (WHT)	
18	4-947-472-01	SPRING (9-1)		38	4-951-290-01	STYLUS (CN234)	
19	7-685-645-79	SCREW (68)		39	4-947-475-01	MAIN CABINET (G)	
20	A-4660-302-A	RETURN ASSY, LEVER		40	4-947-496-01	SPRING (34)	
21	3-659-350-01	WASHER		* 41	4-947-477-01	CUEING (BASE)	
22	4-890-173-01	WASHER		42	4-947-485-01	SPRING (22)	
23	1-555-116-11	PHONO CORD		43	4-947-490-01	ARM CLIP	
24	4-947-495-01	WIPER REJECT		44	4-947-491-01	ARM REST	
25	A-4604-916-A	GEAR ASSY, SPUR		45	4-950-485-01	KNOB RETURN	
26	1-251-028-11	CARTRIDGE (MAIN)		46	4-950-486-01	KNOB SPEED	
27	4-950-497-01	FOOT SEAT		47	4-947-464-01	COUNTER WEIGHT	
28	4-950-490-01	PLASTIC STAND		* 48	4-947-487-01	RETURN LINK	
29	4-950-489-01	FOOT RING		49	1-644-410-11	P. C BOARD	
				50	4-948-101-01	SPRING (38)	

ELECTRICAL PARTS LIST

NOTE:

The components identified by mark Δ or dotted line with mark Δ are critical for safety.

Replace only with part number specified.

When indicating parts by reference number, please include the board name.

- Due to standardization, replacements in the parts list may be different from the parts specified in the diagrams or the components used on the set.

- XX, -X mean standardized parts, so they may have some difference from the original one.
- RESISTORS
All resistors are in ohms
METAL : Metal-film resistor
METAL OXIDE : Metal Oxide-film resistor
F : nonflammable
- Items marked "*****" are not stocked since they are seldom required for routine service. Some delay should be anticipated when ordering these items.

- SEMICONDUCTORS
In each case, u : μ , for example :
uA... : μ A..., uPA... : μ PA...,
uPB... : μ PB..., uPC... : μ PC...,
uPD... : μ PD...
- CAPACITORS
MF : μ F, PF : μ F
- COILS
MMH : mH, uH : μ H

Ref. No.	Part No.	Description	Remarks	Ref. No.	Part No.	Description	Remarks
23	1-696-142-11	PHONO CORD		HARDWARE LIST			
30	1-696-145-11	DC CORD					
* 49	1-644-410-11	P.C BOARD					
M1	A-4604-945-A	MOTOR ASSY					
SW1	1-570-666-11	SWITCH (MOTOR)					
SW2	1-571-089-11	PUSH SWITCH (SPEED)					

ACCESSORIES & PACKING MATERIALS							

*	4-947-532-01	SNOW BOX (L)		#1	7-621-773-87	SCREW (64)	
*	4-947-533-01	SNOW BOX (R)		#2	7-623-210-22	WASHER (57)	
*	4-957-005-01	CARTON		#3	7-624-110-04	6MM E RING	
				#4	7-685-105-01	SCREW (59)	
				#5	7-685-147-21	SCREW (70)	
				#6	7-685-646-79	SCREW (62)	
				#7	7-685-647-79	SCREW (58)	
				#8	7-688-005-01	WASHER (69)	

Sony Corporation

Audio Group

- 6 -

English

93B197015-1

Printed in Singapore

© 1993.2

9-957-695-11

Published by Audio Corporate Planning Group