

# PS-LX45

## SERVICE MANUAL

*AEP Model  
E Model*

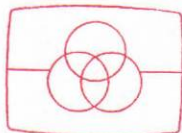

Free service manuals  
Gratis schema's

Digitized by

www.freesevicemanuals.info



### SPECIFICATIONS

#### Turntable

Platter	30 cm (12 in.) aluminum-alloy diecast
Motor	DC servo motor
Drive system	Belt drive
Speed	33 $\frac{1}{3}$ rpm/45 rpm switchable
Wow and flutter	0.15% (WRMS)
Signal-to-noise ratio	65 dB (DIN-B)
Automatic system	Return, reject, lead in.

#### Tonearm

Type	Dynamically balanced
Pivot-to stylus length	206 mm (7 $\frac{7}{8}$ in.)
Overall arm length	235 mm (9 $\frac{3}{8}$ in.)

#### Cartridge

Type	Moving magnet type
Frequency response	20 Hz–20 kHz
Stylus	ND-155G

#### General

Dimensions	355 × 100 × 340 mm (w/h/d) (14 × 4 × 13 $\frac{1}{2}$ inches)
Weight	Approx. 2.6 kg (4 lb 14 oz)
Power requirements	The model for Europe: 220 V AC, 50/60 Hz The model for other countries: 110 – 120 V, 220 – 240 V adjustable, 50/60 Hz
Power requirements	AEP model: 220 V AC, 50/60 Hz E model: 110 – 120 V, 220 – 240 V adjustable, 50/60 Hz

### SAFETY-RELATED COMPONENT WARNING!!

COMPONENTS IDENTIFIED BY SHADING AND MARK  ON THE SCHEMATIC DIAGRAMS AND IN THE PARTS LIST ARE CRITICAL TO SAFE OPERATION. REPLACE THESE COMPONENTS WITH SONY PARTS WHOSE PART NUMBERS APPEAR AS SHOWN IN THIS MANUAL OR IN SUPPLEMENTS PUBLISHED BY SONY.

### Note for Cartridge

Be careful not to use any cartridge except for specified one (Part No.: 1-549-133-11 VL-55G) as balance weight of pick up arm assy is fixed.

### REPLACING THE STYLUS

Replace the stylus after about 400 hours of use because using a worn stylus will damage records. An ND-155G replacement stylus is available at your Sony dealer. Be sure to turn the amplifier off before proceeding with replacement.

- 1 While holding the cartridge, detach the stylus assembly as illustrated.
- 2 Insert the new stylus into the cartridge.

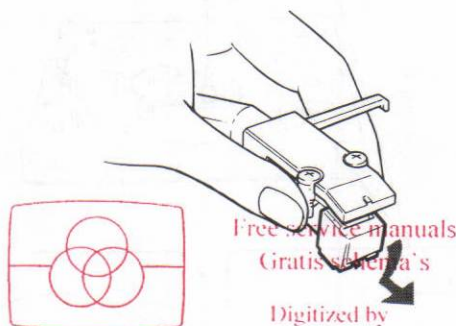

www.freesevicemanuals.info

# STEREO TURNTABLE SYSTEM SONY®

AUD



## SECTION 1 OUTLINE

### LOCATION AND FUNCTION OF CONTROLS

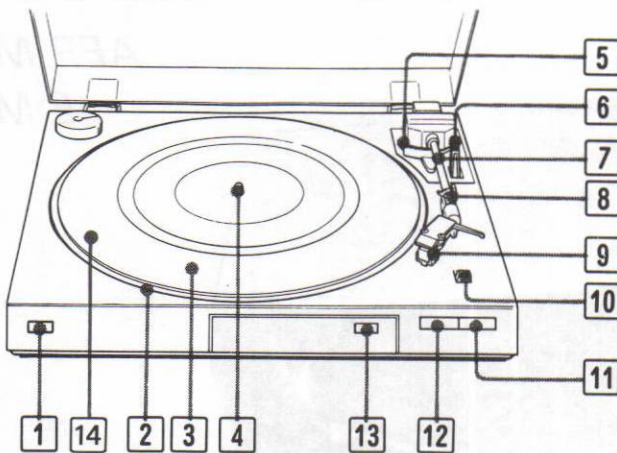

**1 POWER switch**

**2 Turntable platter**

**3 Rubber mat**

**4 Center spindle**

**5 Drop point adjustment hole**

**6 Cueing lever (▼/▼)**

**7 Tonearm**

**8 Arm rest**

**9 Cartridge**

**10 SIZE SELECTOR**

Allows selection of 17 cm (7 inch) or 30 cm (12 inch) records.

**11 START button**

**12 STOP button**

**13 SPEED select button**

Allows selection of 45 rpm or 33 rpm turntable speed.

**14 VOLTAGE SELECTOR (E model)**

### TURNTABLE ASSEMBLY

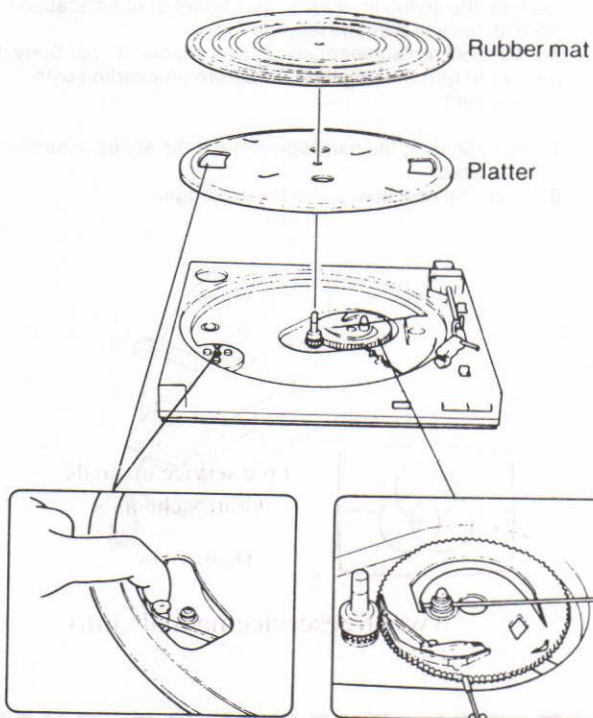

Hook the belt on the motor pulley.

If the belt is removed from the platter, replace it with the glossy side outward.



## SECTION 2

### ADJUSTMENTS

#### TONEARM DROP POINT ADJUSTMENT

The tonearm drop-point during auto play has been factory-adjusted. If necessary, readjust it as follows:

- 1 Secure the tonearm to the arm rest.
- 2 Insert a screwdriver into the tonearm drop-point adjustment hole.

To move the drop-point inward: turn the screw clockwise.

To move the drop-point outward: turn the screw counterclockwise.

- 3 Start auto play and check that the stylus lowers at the correct point.

#### Note

- If the drop point is correctly adjusted for a 30 cm record, it will also be correct for a 17 cm record.
- If the tonearm will not return to the arm rest automatically after playing, turn the screw counterclockwise.

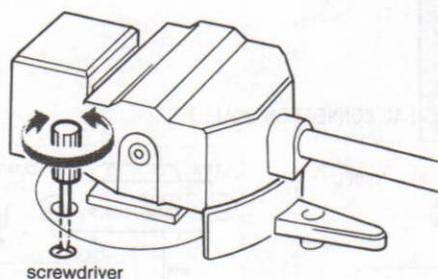

#### Speed Adjustment

**Note:** Be sure to perform 45rpm adjustment before 33 rpm.

1. Place a stroboscope board on the turntable sheet.
2. Set the SPEED switch to 45.

Press the START button.

Adjust RV2 so that the stripped pattern of stroboscope board is stationary.

3. Set the SPEED switch to 33.

Adjust RV1 in the same way.

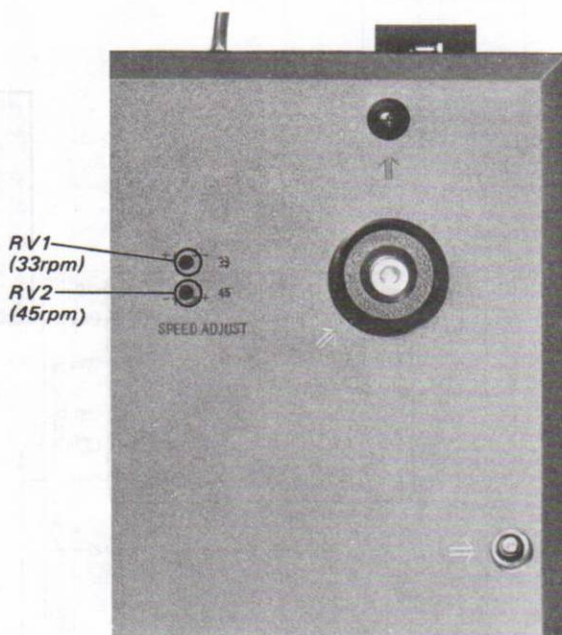

SECTION 3  
DIAGRAMS

## 3-1. MOUNTING DIAGRAM

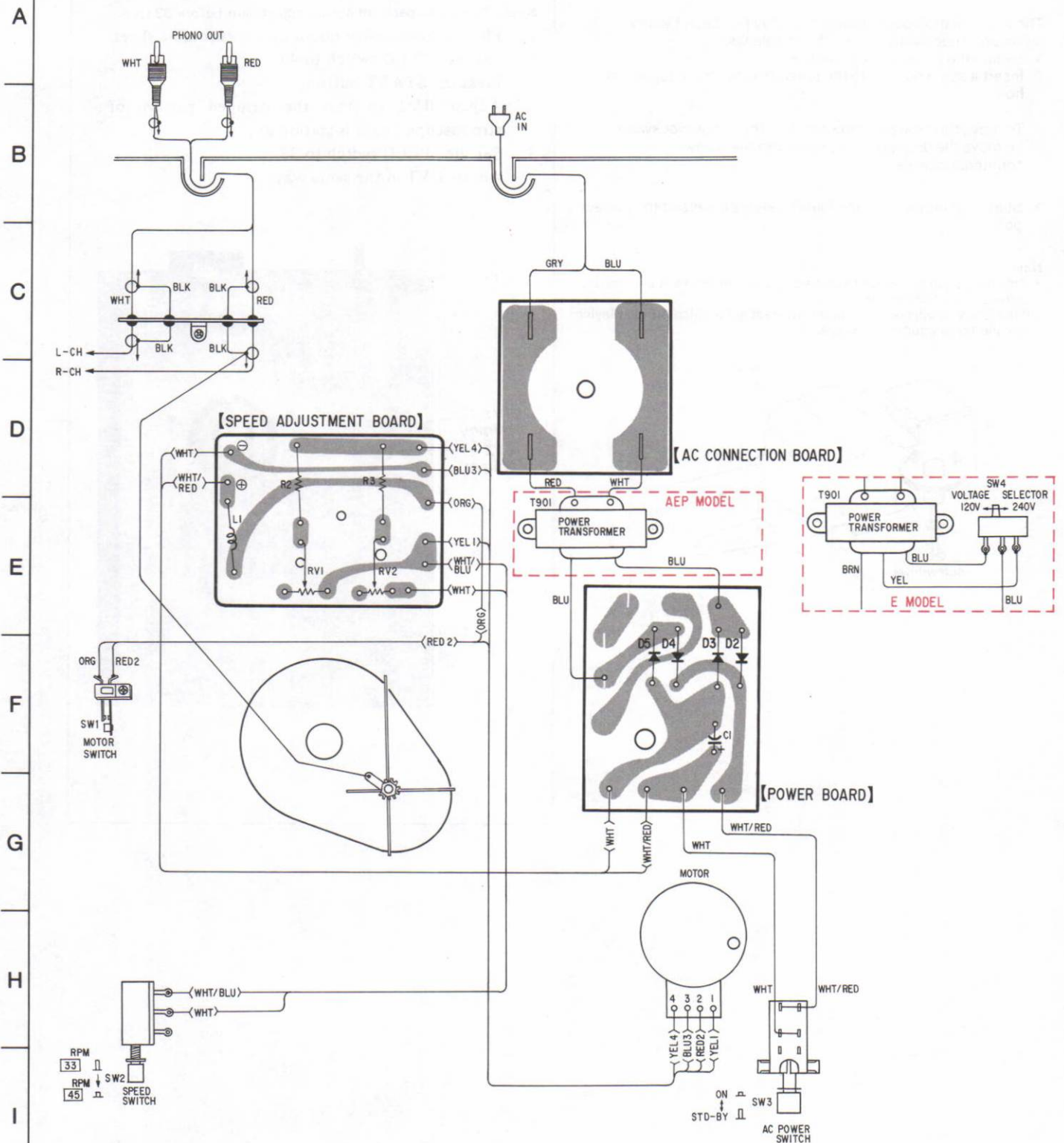



## 3-2. SCHEMATIC DIAGRAM

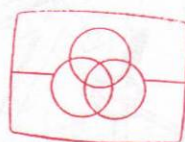
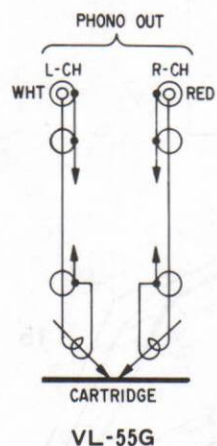

Free service manuals  
Gratis schema's

Digitized by

www.freesevicemanuals.info

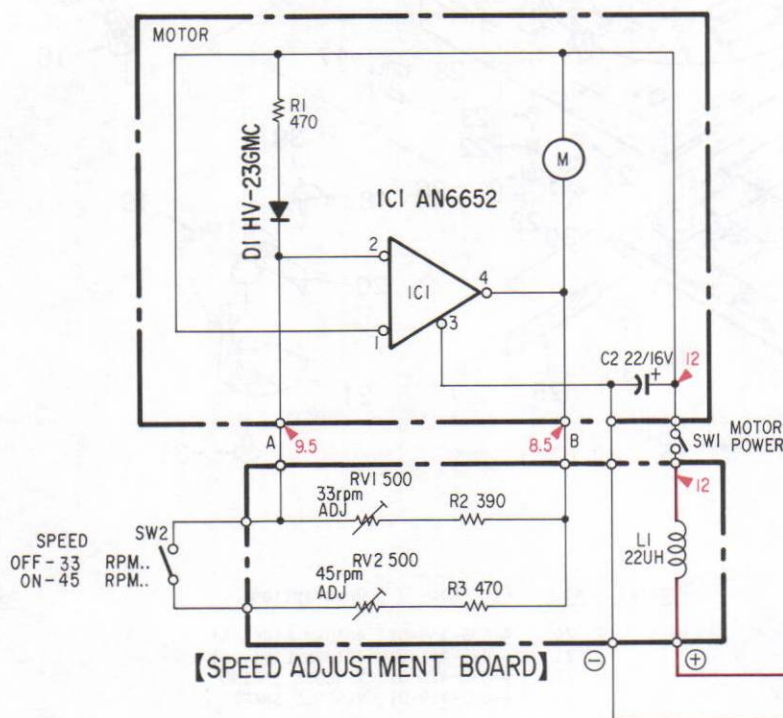
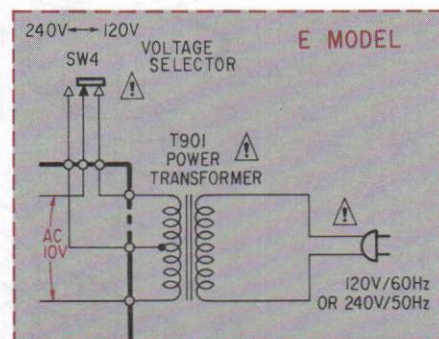

SW3 POWER SWITCH  
ON → STD-BY

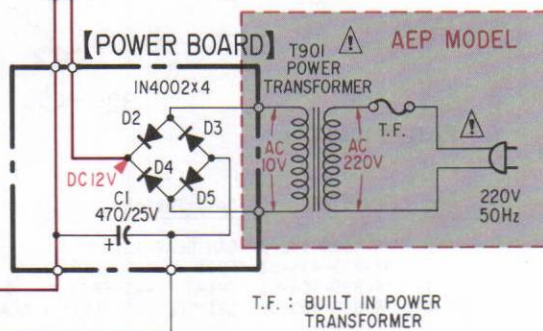

Note: The components identified by shading and mark ⚠ are critical for safety. Replace only with part number specified.

# SECTION 4

## EXPLODED VIEWS AND PARTS LIST

### EXPLODED VIEW

#### NOTE:

- The mechanical parts with no reference number in the exploded views are not supplied.
- Items marked "\*" are not stocked since they are seldom required for routine service. Some delay should be anticipated when ordering these items.

The construction parts of an assembled part are indicated with a collation number in the remark column.

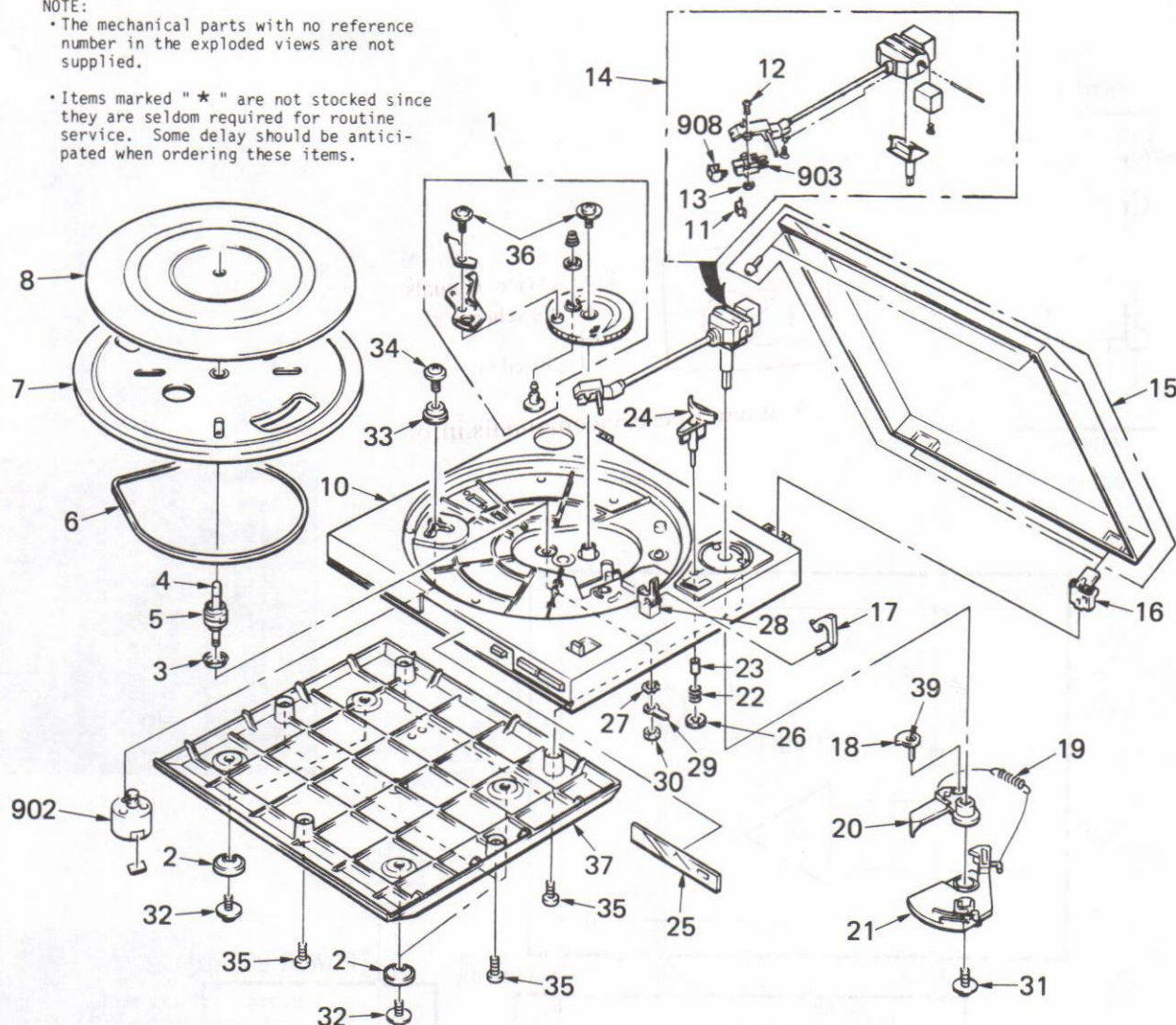

### PARTS LIST

No.	Part No.	Description	Remarks	No.	Part No.	Description	Remarks
1	X-4895-402-2	CAM GEAR ASSY		20	4-895-459-01	RETURN LINK (A)	
2	*4-895-435-01	FOOT		21	4-895-461-01	RETURN LINK (B)	
3	*4-895-404-01	SPINDLE WASHER		22	4-895-420-01	VISCOUS SPRING	
4	4-895-403-02	SPINDLE ASSY (W/T.T GEAR)		23	4-895-419-01	VISCOUS SHAFT	
5	4-895-489-01	GEAR, CENTER		24	*4-895-412-01	LIFT PLATFORM	
6	4-880-655-01	BELT		25	4-895-854-01	PANEL, FRONT	
7	X-4909-004-1	TURNTABLE		26	4-303-605-00	PUSH NUT DIA.3	
8	4-877-807-01	SHEET, TURNTABLE		27	4-895-443-01	W. GOAR 0003 ZN3A	
10	*4-895-855-01	CABINET		28	4-895-417-01	P.U. REST	
11	4-895-474-01	CARTRIDGE COVER		29	4-895-444-01	EARTH TERMINAL (B)	
12	7-621-775-20	2-BID 2610 ZN3K		30	4-895-445-01	NUT 50 ZN3A	
13	4-895-472-01	NUT 26 ZN3K		31	4-895-454-01	7-BID 3012 ZN3A 12D	
14	X-4895-403-1	PICK UP ARM ASSY		32	4-895-430-01	7-BID 3008 ZN3A 12D	
15	4-895-480-01	DUST COVER ASSY		33	4-895-414-01	GROMMET (A)	
16	4-895-410-01	HINGE ASSY		34	4-895-413-01	SCREW	
17	4-895-418-01	P.U. TUBE HOOK		35	4-895-860-01	SCREW	
18	4-895-458-01	ADJUST CAM		36	7-685-646-79	7-BID 3008 ZN3A	
19	4-895-460-01	ADJUST SPRING		37	*4-895-859-01	BOARD, BOTTOM	
				39	4-895-456-01	TRIP CLUTCH SPRING	

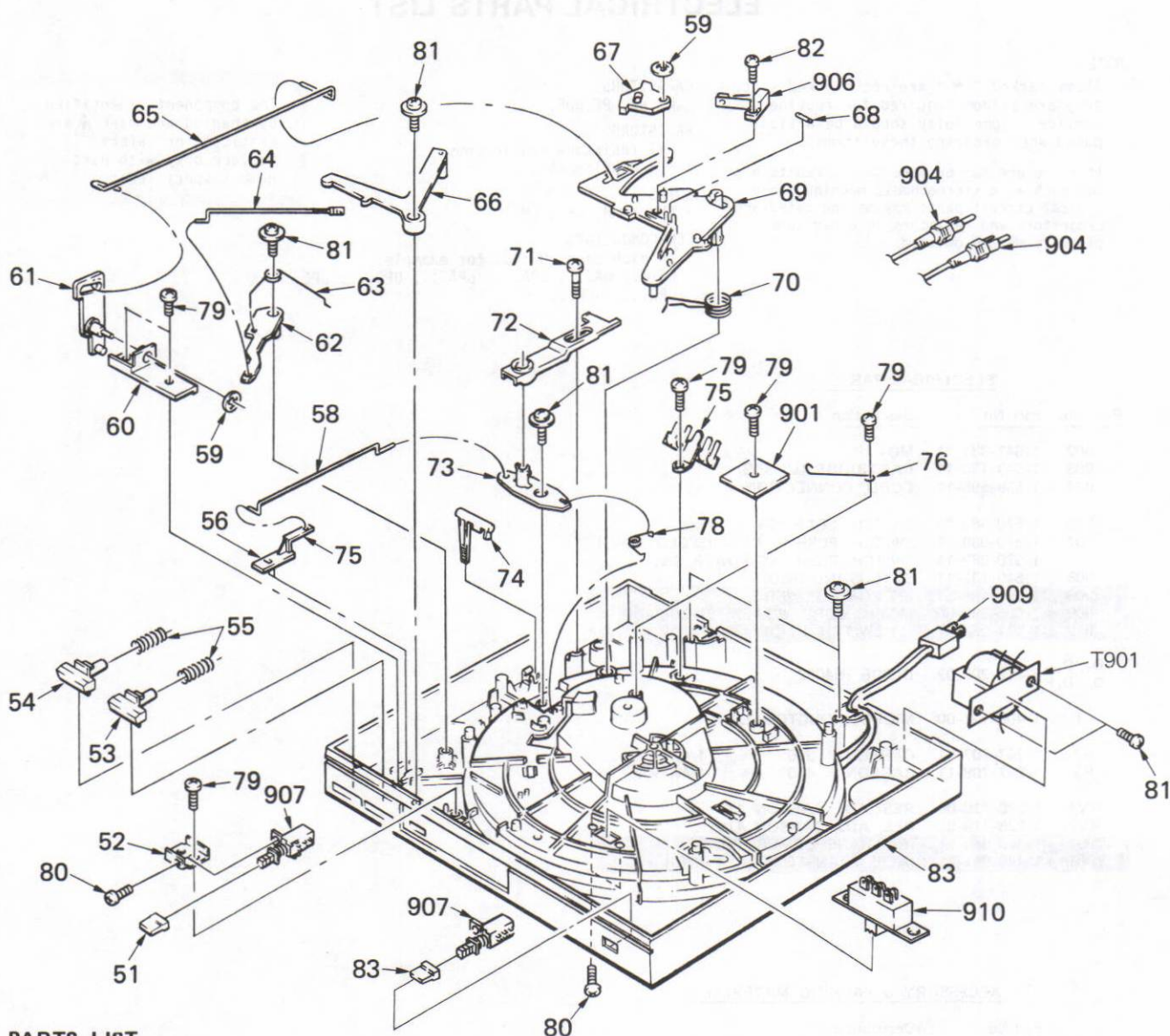

**PARTS LIST**

No.	Part No.	Description	Remarks	No.	Part No.	Description	Remarks
51	4-895-450-01	SPEED BUTTON		66	4-895-446-01	CONTROL LEVER	
52	*4-895-449-01	SW. HOLDER		67	4-895-441-01	CAM	
53	4-895-853-01	BUTTON, STOP		68	4-895-429-01	SECURING RUBBER	
54	4-895-852-01	BUTTON, START		69	4-895-436-01	CONTROL ARM	
55	4-895-448-01	CONTROL BUTTON SPRING		70	4-895-437-01	CONTROL ARM SPRING (3)	
56	4-895-429-01	SECURING RUBBER (1)		71	4-895-422-01	7-BID 3006 ZN3A 10D	
57	4-895-857-01	KNOB		72	4-895-428-01	SIZE SELECTOR	
58	*4-895-858-01	WIRE, SELECTOR		73	4-895-425-01	SIZE SELECTOR HOLDER	
59	4-895-442-01	PUSH NUT DIA.3		74	4-895-421-01	CUE LEVER	
60	4-895-447-01	CONTROL HOLDER		75	*4-895-423-01	LUG TERMINAL	
61	4-895-431-01	CONTROL LEVER FOR START		76	4-895-484-01	WIRE, CONTROL ARM	
62	4-895-433-01	REJ ST LEVER		77	*4-895-855-01	CABINET	
63	4-895-434-01	SHIFT SPRING (2)		78	4-895-424-01	SPEED SHIFT CAM SPRING (1)	
64	4-895-856-01	SPRING		80	7-621-775-20	2-BID 2605 ZN3A	
65	*4-895-432-01	CONTROL WIRE		81	4-895-430-01	7-BID 3008 ZN3A 12D	
				82	4-895-440-01	7-BID 3014 ZN3A	
				83	4-895-896-01	BUTTON, POWER	
				909	Δ1-551-188-51	(E) CORD, POWER	
				909	Δ1-555-990-00	(AEP) CORD, POWER, EURO-PLUG	
				T901	Δ1-448-940-11	(E) TRANSFORMER, POWER	
				T901	Δ1-448-941-11	(AEP) TRANSFORMER, POWER	
				910	Δ1-571-088-11	(E) ... SWITCH, SLIDE (SW <sub>4</sub> )	

The components identified by shading and mark **Δ** are critical for safety. Replace only with part number specified.

## SECTION 5

### ELECTRICAL PARTS LIST

## NOTE:

- Items marked " ★ " are not stocked since they are seldom required for routine service. Some delay should be anticipated when ordering these items.
- If there are two or more same circuits in a set such as a stereophonic machine, only typical circuit parts may be indicated and capacitors and resistors in other same circuits may be omitted.

## CAPACITORS:

MF:  $\mu$ F, PF:  $\mu$ F.

## RESISTORS

- All resistors are in ohms.
- F : nonflammable

## COILS

- MMH : mH, UH :  $\mu$ H

## SEMICONDUCTORS

In each case, U :  $\mu$ , for example:UA...:  $\mu$ A..., UPA...:  $\mu$ PA..., UPC...:  $\mu$ PC,UPD...:  $\mu$ PD...

The components identified by shading and mark  $\Delta$  are critical for safety. Replace only with part number specified.

## ELECTRICAL PARTS

Ref. No.	Part No.	Description
902	1-541-331-11	MOTOR
903	1-549-133-11	CARTRIDGE (VL-55G)
904	1-558-595-11	CORD, CONNECTION
906	1-570-666-11	SWITCH, LEAF (SW <sub>1</sub> )
907	1-570-089-11	SWITCH, PUSH (1 KEY) (SPEED) (SW <sub>2</sub> )
	1-570-089-11	SWITCH, PUSH (AC POWER SW <sub>3</sub> )
908	1-549-132-11	STYLUS (ND-155D)
909	$\Delta$ 1-551-188-51	(E) CORD, POWER
909	$\Delta$ 1-555-990-00	(AEP) ... CORD, POWER, EURO-PLUG
910	$\Delta$ 1-571-088-11	(E) SWITCH, SLIDE (SW <sub>4</sub> )
D <sub>2</sub> , D <sub>3</sub> D <sub>4</sub> , D <sub>5</sub> } 8-719-200-02 DIODE IN4002		
L1	1-408-121-00	MICRO INDUCTOR 22UH
R2	1-247-707-11	CARBON 390 5% 1/4W F
R3	1-247-708-11	CARBON 470 5% 1/4W F
RV1	1-228-719-00	RES, ADJ, CARBON 470
RV2	1-228-719-00	RES, ADJ, CARBON 470
T901	$\Delta$ 1-448-940-11	(E) TRANSFORMER, POWER
T901	$\Delta$ 1-448-941-11	(AEP) TRANSFORMER, POWER

## ACCESSORY &amp; PACKING MATERIAL

Part No.	Description
3-701-630-00	BAG, PLASTIC
3-701-806-00	ADAPTOR, 45
4-895-476-01	CUSHION (R)
4-895-477-01	CUSHION (L)
4-895-478-01	INNER PLATE
4-895-483-01	SLEEVE, DUST COVER
4-895-862-01	BAG, (SET), POLYETHYLENE
4-895-863-01	BAG, (MAT), POLYETHYLENE
3-765-724-41	(AEP) MANUAL, INSTRUCTION
3-765-724-11	(AEP, E) MANUAL, INSTRUCTION
$\Delta$ 1-526-565-12	(E) AC-PLUG ADAPTOR
4-895-864-01	CARTON, INDIVIDUAL